

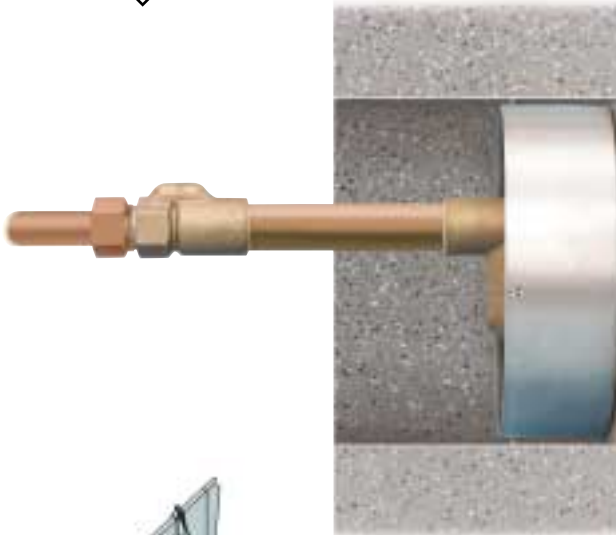

Zurn Z1322 and Z1332 Ecolotrols: A Perfect Fit

For Installation In Tilt-Up Construction



Patent Pending

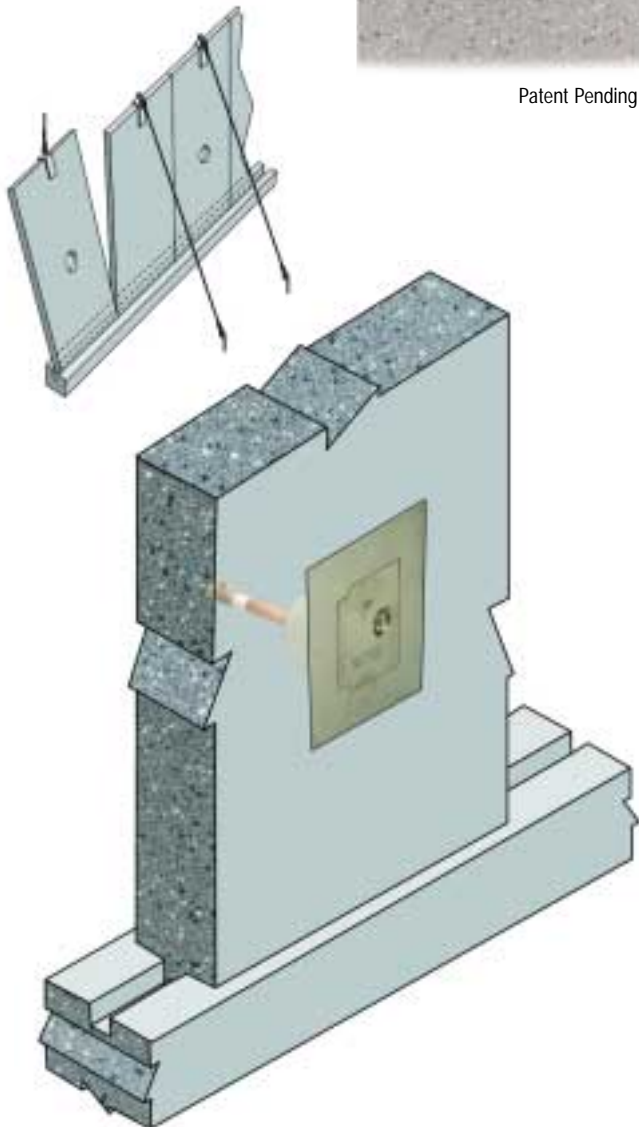

The 7-7/8" diameter sleeve of the Zurn Z1322 and Z1332 Ecolotrol wall hydrants is designed exclusively for tilt-up installations. They have many benefits over square or rectangular hole type installations, including:

- coring an 8" diameter hole in the wall results in time and labor savings over trying to hammer drill a square or rectangular hole;
- coring makes a smooth and clean cut opening without damaging the wall or chipping the interior wall surface, whereas a square or rectangular hole can crack or damage the precast wall during hammer drilling;
- the wall's smooth interior surface is easy to insulate (if required);
- no materials or labor are required to repair the interior wall surface;
- the round sleeves of the Z1322 and Z1332 Ecolotrol wall hydrants have holes that allow the installer to secure them to the wall with hardware;
- the wide box faces of the Z1322 and Z1332 Ecolotrol wall hydrants fits flush with the wall surface and covers the 8" diameter hole;
- the square box face flanges of the Z1322 and Z1332 Ecolotrol wall hydrants provide surface areas that seal and waterproof (if required);
- and the tight, secure fit provides for vermin-proof installation.



ZURN INDUSTRIES, LLC
SPECIFICATION DRAINAGE OPERATION
1801 PITTSBURGH AVENUE · ERIE, PA, U.S.A. 16502
PHONE: 814/455-0921 · FAX: 814/454-7929 · www.zurn.com

In Canada:

ZURN INDUSTRIES LIMITED
3544 NASHUA DRIVE · MISSISSAUGA, ONTARIO L4V 1L2
PHONE: 905/405-8272 · FAX: 905/405-1292

Zurn Z1322 and Z1332 Engineering Specifications

Z1322 ENGINEERING SPECIFICATION: ZURN Z1322 Encased Ecolotrol anti-siphon, automatic draining wall hydrant for flush installation in 8" [203 mm] diameter cored-hole concrete exterior wall. Complete with copper casing, all bronze interior parts with one-half turn ceramic disc cartridge and combination 3/4" [19 mm] female solder and 3/4" [19 mm] male pipe thread inlet. Stainless steel large flange box and hinged cover with operating key lock and "WATER" stamped on cover. (All solder connections are lead free.)

Note: During normal operation, the hydrant may take as long as one minute to complete the self-drainage process. This drainage feature should not be mistaken for an unsealed shut-off of the hydrant, and over-tightening of the operating coupling is not necessary.

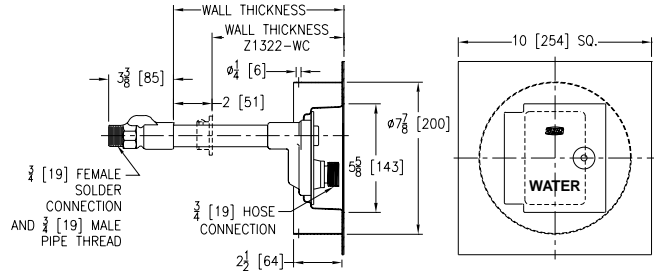

Wall Thickness Inches [mm]	6" [152]	8" [203]	10" [254]	12" [305]	14" [356]	16" [406]	18" [457]	20" [508]	22" [559]	24" [610]	26" [660]	30" [762]
Overall Length* Inches [mm]	9 1/4" [235]	11 1/4" [286]	13 1/4" [337]	15 1/4" [387]	17 1/4" [438]	19 1/4" [489]	21 1/4" [540]	23 1/4" [591]	25 1/4" [641]	27 1/4" [692]	29 1/4" [743]	33 1/4" [845]
Approx. Weight Lbs. [Kg]	5 [2]	5 [2]	6 [3]	6 [3]	6 [3]	7 [3]	7 [3]	8 [4]	8 [4]	8 [4]	10 [5]	10 [5]

*3/4" [19 mm] female solder and 3/4" [19 mm] male pipe thread connections.

Z1332 ENGINEERING SPECIFICATION: ZURN Z1332 Encased Ecolotrol anti-siphon wall hydrant for moderate climate and interior wall installation. For flush installation in 8" [203 mm] diameter cored-hole concrete wall. Complete with integral backflow preventer, all bronze interior parts, with one-half turn ceramic disc cartridge and combination 3/4" [19 mm] female solder and 3/4" [19 mm] male pipe thread inlet. Stainless steel large flange box and hinged cover with operating key lock and "WATER" stamped on cover.

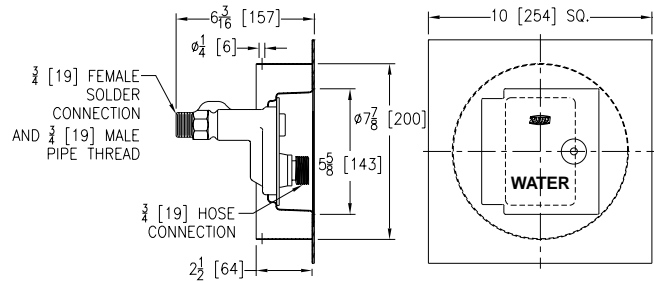

ZURN INDUSTRIES, LLC SPECIFICATION DRAINAGE OPERATION
1801 PITTSBURGH AVENUE · ERIE, PA, U.S.A. 16502 · PHONE: 814/455-0921 · FAX: 814/875-1402 · WEBSITE: www.zurn.com

In Canada:

ZURN INDUSTRIES LIMITED
3544 NASHUA DRIVE · MISSISSAUGA, ONTARIO L4V 1L2 · PHONE: 905/405-8272 · FAX: 905/405-1292